



New Bobcat S330



Why the S330?



- **Customer Request**

- The skid steer loader market has continued its trend toward larger capacity machines
- Greatest increase has been in the top AEM SSL size class

- **Dealer Request**

- Replacement of older Bobcat models
- Competitive pressure



What is the S330?



**3300 lbs
Rated
Operating
Capacity**

**BCT tipping : 3048 kg
BCT ROC : 1497 kg
ISO 14397-1 ROC: 1542 kg**

COUNTERWEIGHTS

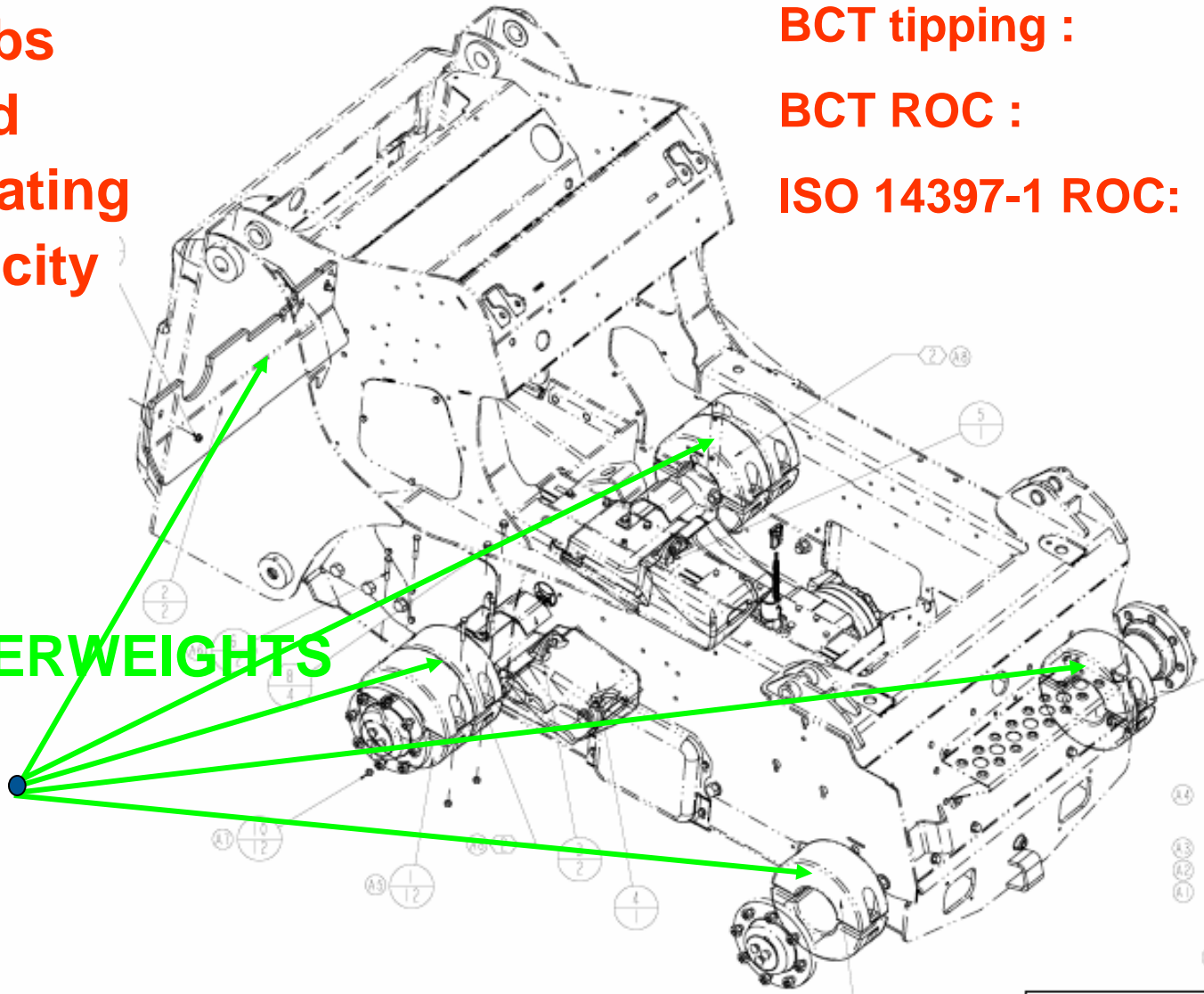

What is the S330?



- **S250/S300 Frame**
- **New engine (85 HP, 3.8 l - more displacement)**
- **Big tyres (14 x 17.5 Heavy Duty – 14 ply)**
- **Two-speed travel – Standard equipment**
- **Suspension seat with 3-pt belt – Standard equipment**



Factory Options



- **CONTROLS:**

- Mechanical pedals (default)
- Advanced Control System (ACS)
- Advanced Hand Controls (AHC)
- Selectable Joystick Controls (SJC)

- **TYRES:**

- Heavy Duty tyres (default)
- Severe Duty Tyres
- Severe Duty PolyFill
- Solid Flex

- **High-Flow hydraulics 151 lpm**

- **Deluxe Instrumentation (keyless)**

- **Power Bob-Tach**

- **Cab**

- Deluxe heated cab
- Air conditioning

- **Hydraulic bucket positioning**

- Default on European machines (E-version)
- Optional on B-machines (Middle East & Africa)



Where do I sell the S330?



- Lift and carry applications
- High-Flow applications
- Heavy digging applications
- Demolition applications



Where do I sell the S330?



GRADING



Where do I sell the S330?



**S330
WITH A
TILLER**



Where do I sell the S330?



S330 WITH A FORESTRY CUTTER



Where do I sell the S330?

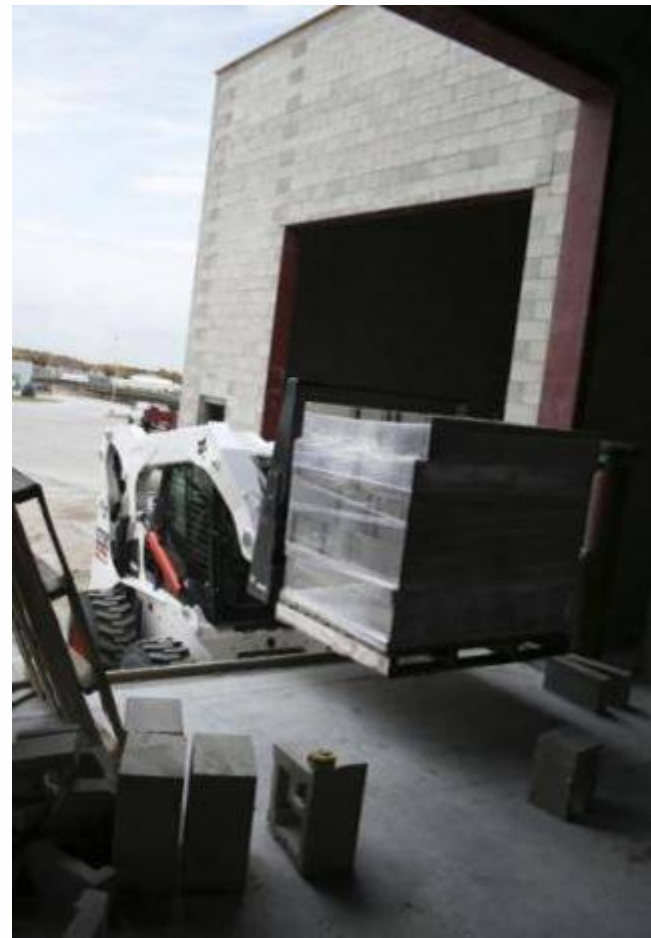

S330 WITH PALLET FORKS



Where do I sell the S330?



DUMPING MATERIAL





TESTOSTERONE COMES STANDARD.



Unleash a better way. Unrivaled versatility. Unequaled agility. Unsurpassed performance and innovation. That's why Bobcat is the world leader in compact equipment. No one offers more ways to get your work done... or to found your will.

**50 YEARS
UNLEASHED**

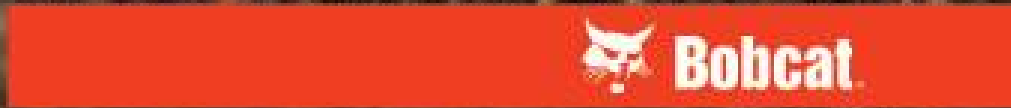

www.bobcat.com 1.866.833.7638 ext 887

One Tough Animal

©2008 Bobcat Company. All rights reserved. Bobcat is a registered trademark of Bobcat Company. All other trademarks are the property of their respective owners.



WANT POWER?
YOU GOT IT!

AdCenter
 Preview only

Bobcat® S330 3304 Skid Steer Loader

3,300 Rated Operating Capacity	10, 10 Lift Height	85 Rated Power	6.9-12.0 Rated Torque
---	------------------------------	--------------------------	---------------------------------

Brutal working conditions and strenuous jobs don't stand a chance against this monster. If you need a heavy-duty loader for heavy-duty applications, the new Bobcat S330 is your machine - with more horsepower, more capacity, more pushing power and more drive torque!

Authorized Bobcat Dealer

Bobcat of Futureville
 101 10th Street North • Fargo, ND • 877-714-4487

One Tough Animal.



Bobcat® and approved trademarks of Bobcat Company. © 2008 Bobcat.

www.bobcatoffutureville.com

WANT POWER?
YOU GOT IT!

AdCenter
 Preview only

Bobcat® S290 2904 Skid Steer Loader

3,300 Rated Operating Capacity	10, 10 Lift Height	85 Rated Power	6.9-12.0 Rated Torque
---	------------------------------	--------------------------	---------------------------------

Brutal working conditions and strenuous jobs don't stand a chance against this monster. If you need a heavy-duty loader for heavy-duty applications, the new Bobcat S290 is your machine - with more horsepower, more capacity, more pushing power and more drive torque!

Authorized Bobcat Dealer

Bobcat of Futureville
 101 10th Street North • Fargo, ND • 877-714-4487

One Tough Animal.



Bobcat® and approved trademarks of Bobcat Company. © 2008 Bobcat.

www.bobcatoffutureville.com

Cooling Package Upgrade



Why?

- Bigger engine in the S330
- Landclearing applications rapidly growing
- Increase of SJC, HF, and AC units sold



Cooling Fan Comparison



Old centrifugal style



New axial style

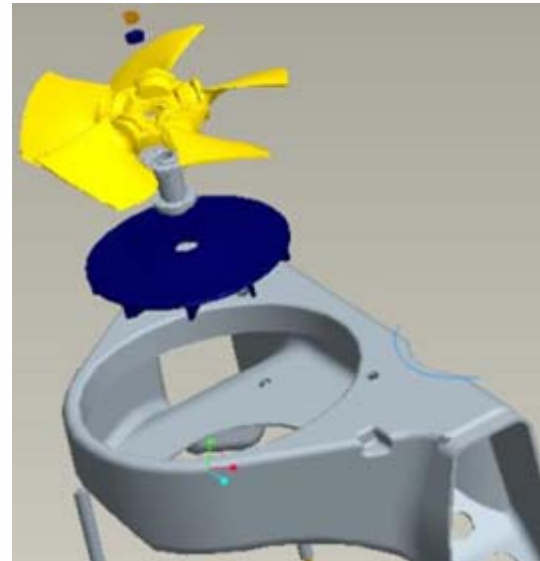

Cooling Package



- Increase in overall cooling of 30%
- Implementation on all large frame loaders since end 2006, now also on the new S330
- Only visible change to loaders is the left access panel



Left access panel now has louvers in it for extra airflow discharge

Relative Alignment - Competition



Bobcat	S205	S220	S250	S300	S330		
Caterpillar	236B/242B	246B/248B	252B	262B/268B			
New Holland		L180	L185	L190			
Case	430	435/440	445	450	465		
Gehl	5640E	5640E T	6640E				7810E
Mustang	2066	2076	2086			2099	2109

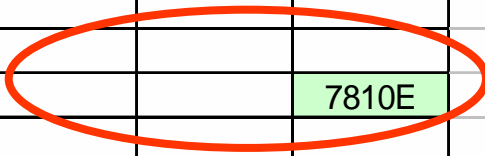

Competition – GEHL 7810



- Engine-pump direct coupling vs Bobcat belt drive
- (open) Tailgate & cooling package vs Bobcat dual path
- Ground clearance vs Bobcat keel-shaped & Bobcat transmission advantage
- less visibility when arms raised vs design of Bobcat vertical lift arms
- lights at the exterior of the cab
- exhaust pipe not protected

Operator Space



- + Easy entry/exit
- + A lot of space between the controls

Visibility



- With lift arms lowered, excellent visibility on the tyres
- Lift arms designed to maximize visibility
 - Holes in the lower, rear corners of side screen increase visibility on the tyres



Service Access

Bobcat S330 offers easy accessibility to **9** maintenance points by simply opening the tailgate

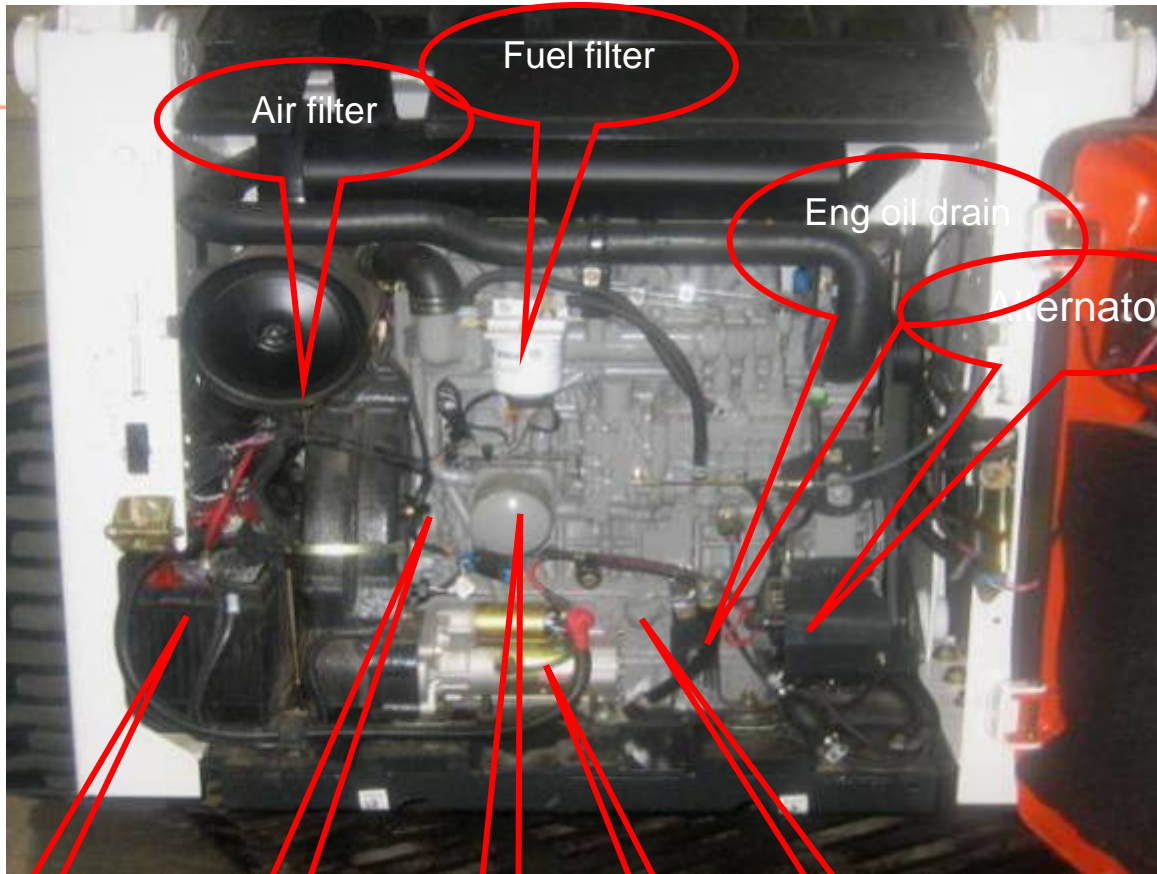

Air filter

Fuel filter

Eng oil drain

Alternator

Battery

Eng oil dipstick

Eng oil filter

Starter

Eng oil fill



Simple thumb movement Click trigger for continuous flow

Bobcat

- Momentary forward and reverse flow is achieved by moving the RH center paddle switch left or right
- Continuous flow is achieved by simply activating the RH front trigger switch

Comfort cab



Bobcat pivot pins all in the same plane & are all straddle mounted

Bobcat's lift arms were designed to keep every pin in the same plane. Stronger design - Reduces lateral deflection. Patented.

Ordering & Pricing



- **Machines can be ordered as of now**
- **Pricing is in the system: for details contact your CST representative**
- **Production starts end of May**
- **Availability as of June 2008**





Bobcat®